



terrazze
sul parco



Sheet format A3
Floor plan scale 1:100

[BUILDING 6

Unit 03

Ground-floor residence with three bedrooms and a private garden.

A separate, well-defined entrance leads into the residence. The kitchen is separate, eat-in and generously sized. The living area is arranged in a spacious environment, with distinct dining and conversation areas overlooking the large outdoor terrace. A hallway leads to the sleeping area, where there is a master bedroom with en-suite bathroom and walk-in wardrobe, two additional bedrooms and a full bathroom. All main rooms overlook the private garden, which extends on three sides of the residence, creating a natural continuity between indoors and outdoors. The covered porch, accessible from the living area, is ideal for relaxing outdoors.

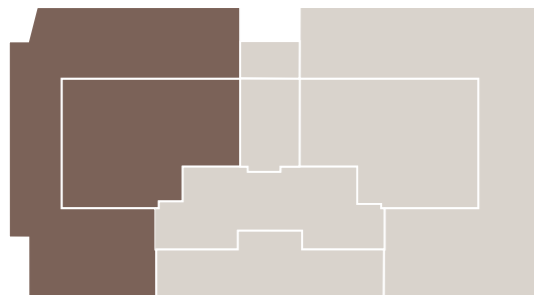

INFORMATIONS

TPOLOGY	Three-bedroom apartment
FLOOR	Ground floor
COMMERCIAL SURFACE	165 sqm
EXPECTED DELIVERY DATE	February 2027
ENERGY CLASS	A4

Garage and cellar available upon request

